

For more information on Xerox DocuPrint 75/90 and Xerox products call 0800 787 787 or visit us on the web at: www.xerox.com

THE DOCUMENT COMPANY
XEROX

XEROX DOCUPRINT SERIES
DocuPrint 75/90

INCREASE YOUR OPERATIONAL EFFICIENCY | DELIVER YOUR PRODUCTION IN TIGHT PRINT WINDOWS | OUTSTANDING FLEXIBILITY IN ALL IT ENVIRONMENTS

Features and Benefits

PRINTER MODULE

- Xerographic engine with laser raster imaging system for highest quality
- Designed for true productivity, with a heavy-duty cycle of an average 300,000 prints per month
- Print simplex and duplex, high reliability using an internal duplex system. Enables massive savings on paper and distribution costs
- Unique paper handling capacities serve a wider variety of transaction document applications, resulting in major cost saving opportunities
- Full colour Printer Control Console shows current status of the printer module. Even low-skilled operators are able to operate the system
- Load paper while running production that increases both productivity and operator efficiency. No need to halt the printer for paper loading

Resolution

- Laser raster output at 600 dpi and up to 600 x 1200 dpi (PostScript)
- Output will automatically print at the highest possible quality

Speed

- Up to 90 A4 impressions per minute – simplex or duplex
- Up to 43 A3 impressions per minute – simplex or duplex

Paper handling

- 60 to 203 gsm cut-sheet paper weights enables the widest variety of materials to be printed to meet real business requirements
- 148 x 105 mm to 305 x 457 mm paper sizes, including A4 and A3 (varies by tray)
- Maximum image size is 296 x 454 mm
- Transparencies, label stock, tab stock, carbonless paper, pre-perforated stock, safety stock, and other specialised application materials to meet specific customer requirements

Input

- Tray 1-4: 500-sheet capacity of 80 gsm stock
- Tray 5: 50-sheet capacity of 80 gsm stock
- Tray 6: 5,100-sheet capacity of 80 gsm stock

Output

- High-capacity stacker: 2,000 sheets each of 80 gsm stock
- Stapler: 2-50 sheets at 80 gsm. 1 or 2 staples
- Top Tray: minimum of 250 sheets of 80 gsm
- Various finishing options will come available in 2002
- Inline finishing options include signature booklet making and perfect bound like thermal binding

Unique DocuSP functionalities

- Automatic Job Scheduling
- Streaming Mode
- Interrupt and Resume
- Job Ticketing
- Easy to use – GUI
- Print Now feature
- Proof feature
- Job Release and Proof from a Hold Queue
- Subset Offset
- PCL Offset / Separator Command and Subset Finishing
- Socket Gateway set VPS option utility
- Remote Workflow Software
- Automatic Document Imposition
- Xerox Colour Splitter (optional)

FUNCTIONAL CAPABILITIES

Printer Controller

- Enhanced Sun Blade™ 150 workstation with 40 GB hard disk drive, 512 MB RAM, floppy drive and CD-ROM drive
- 17" colour display
- Keyboard, mouse
- Ethernet interface (10 MB/sec or 100 MB/sec)
- Image accelerator/printer interface card
- Power strip with surge protection
- SNMP MIB II
- Optional:
 - 18.2 GB external hard drive for expandable on-line disk storage
 - 4 mm magnetic tape drive for backup, 8 GB capacity
 - External 56 Kbps modem for remote diagnostic with Xerox service
 - Token Ring interface (TCP/IP only)
 - SCSI host adapter kit
 - Channel card
 - QIC and 18/36 Track Tape Drives

Client Environments Supported

- Windows® 95, Windows® 98, Windows NT, Windows 2000, Windows XP (limited functionality)
- Mac OS 7.5.5 and later
- Solaris 2.3 / 2.4 / 2.5.1 / 2.6 / 8.x

PDLs and Data Formats

- Adobe PostScript® 3, PDF, PCL 5e, TIFF, ASCII, VIPP® software (optional), IPDS (optional), LCDS (optional)

Native Network Environments

- TCP/IP (Ethernet/Token Ring)
- AppleTalk (Ethernet only)
- Novell (IPX/SPX and Ethernet II only)
- IBM Channel
- Tape Drive (18/36 Track)

Electrical Requirements

- Printer Controller
 - 115 VAC + 10%, 47-63 Hz, 20 amp service
 - KVA Rating: .35
- Printer Module
 - 75: 115 VAC, 60 Hz, 20 amp service
 - 90: 208/220 VAC, 60 Hz, 20 amp service
 - KVA Rating: 1.45
 - Agency certification: UL 1950, CSA 950, CE Mark, EN 60950-CB for Europe and Scandinavia, NOM, FCC 15-68, EN6100-3-2, EN61000-3-3, EN50082-1, IEC 1000-4-2, IEC 1000-4-3, IEC 000-4-4, IEC 1000-4-5, PTT Approvals (per country standard); EH&S Standards 8.7.0, 8.6.0, 8.17.0, 2.2.0, 2.3.0, FDA IEC 825
 - EME Approval is Class A for all countries: FCC-A, EN 55022-A, CISPR 22 A, ICES-003-A

Physical Characteristics

- Printer Controller – Processor Module
 - Width: 457 mm; Depth: 446 mm; Height: 117 mm; Weight: 12.2 kg
- Printer Controller – 17" Colour Monitor
 - Width: 406 mm; Depth: 450 mm; Height: 414 mm; Weight: 22.5 kg
- Printer Module
 - Width: 1739 mm; Depth: 706 mm; Height: 1008 mm; Weight: 220 kg

Service Access

- Front: 882 mm
- Sides: 454 mm
- Back: 252 mm

the new
small footprint
production printer



Xerox (UK) Ltd.
Bridge House
Uxbridge
Middlesex
UB8 1HS
0800 787 787
www.xerox.co.uk



SIXTH
Technology



©Xerox®, The Document Company®, the digital X and DocuPrint® are trademarks of Xerox Corporation. Other product names used herein are trademarks of their respective owners. Product appearance and/or specifications are subject to change without notice. 01/03 708P8709GBE



new needs...

XEROX DOCUPRINT SERIES
DocuPrint 75/90



Transaction documents and typical publishing documents are converging fast today.

Bills, Statements and Direct Mail are facing more publishing-like elements, like illustrations and shadings.

At the same time flyers and catalogues are facing more data elements, like personalisation or customisation.

These kind of documents require print solutions with the highest flexibility regarding print-media, quality and data stream flexibility.

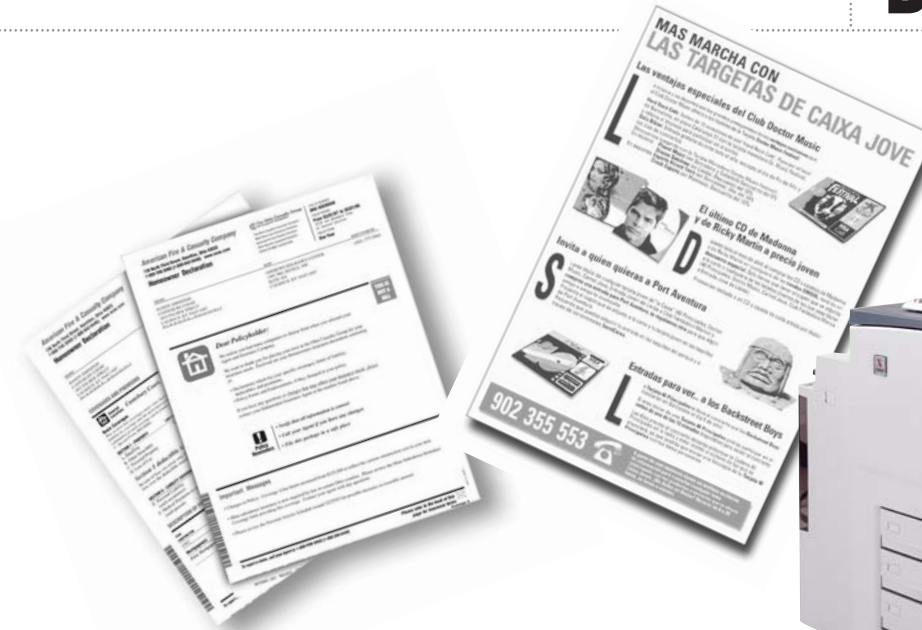

Transaction documents are changing... can you meet these challenges?

The introduction of... the new Xerox DocuPrint 75/90

New customer requirements

Despite e-business and other alternatives cut-sheet transaction printing is still growing in volume.

Some volume may move to highlight colour or full-colour.

However, the majority of the print volume will remain black-and-white.

New volume will come from continuous feed and new applications.

Flexibility, shorter turn around times and better document quality will drive an increasing demand for cut-sheet printing.

The DocuPrint Family of production printers has been designed to deliver true performance in your operations.

Eliminate risks

Your transaction documents can make a true difference for your organisation.

Better documents will drive new business, customer loyalty, better payment of bills, and other business priorities.

Customer Relationship Marketing (CRM) will drive new requirements: both content (data) and layout will change soon. Documents will contain more graphics, illustrations and other 'publishing' like aspects.

Printing of key business documents is often time critical; printer downtime is highly undesired.

For you and other demanding customers, Xerox introduces: DocuPrint 75/90.

Designed with experience

Xerox invented transaction laser printing in 1977. Since then, many new products were introduced, resulting in a dominant market share.

All these year's of experience and knowledge resulted in the development of the Xerox DocuPrint 75/90.

Especially for the demanding market of transaction printing, the following critical features are now available:

- Job integrity (including job recovery)
- Tools to manage deadlines for specific time-critical applications
- Ability to 'schedule' production rather than first-in first-out
- Ability to deliver a complete set per customer, using various print media
- Predictable high productivity; both for long runs and large quantities of short runs.

Meet all your requirements

To meet an even wider range of applications, from various IT environments, DocuPrint 75/90 supports multiple transaction printing data streams.

Some natively, some through well proven software.

On top of this, DocuPrint 75/90 offers the highest print quality in the market.

Finally, you have the widest choice in print media; both in paper weight as well as by paper size.

With six addressable paper trays and in-build stapling capabilities, you will please your most demanding customers!

Controlled by DocuSP software

Like all other new Xerox production solutions, DocuPrint 75/90 is equipped with the DocuSP controller. This offers you seamless, consistent production control across all current and future production devices.

A solid investment for your future!

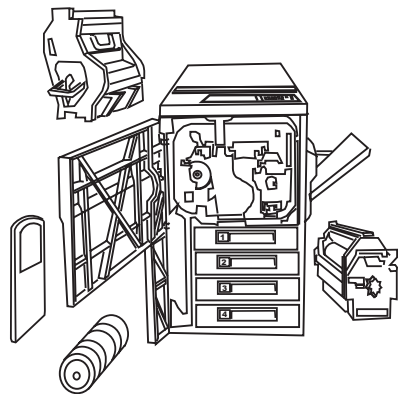

A key strategy to achieve improved dependability is the use of Customer Replaceable Units (CRU).

By periodically changing CRU's, before they fail or performance degrades, Xerox directly influence the customer's up time and reduce interruption due to break downs.

Xerox calls this Influenced Up-time.

This key CRU strategy is possible because Xerox manufactures digital products from a clean sheet design.

...one answer